

University Drive & North Street  
Fairfax, VA 22030

**FOR  
LEASE**

**1,981 SF -  
2,982 SF**

**AVAILABLE**

## HIGHLIGHTS:

- 84,858 SF Mixed Use Center in the heart of Old Town Fairfax, VA
- Convenient on-site parking garage with over 550 parking spaces
- Short walk to Fairfax County Courthouse and Judicial Office, and over 21,000 employees within 1 mile
- Join National and Regional retail tenants:



## 2021 TRAFFIC COUNTS

Chain Bridge Rd: 21,000 AADT  
University Dr: 11,000 AADT  
North St: 20,000 AADT



## DEMOGRAPHICS\*

	1-mile	3-mile	5-mile
Population	14,581	116,362	277,270
Households	4,361	38,904	95,908
Median HH Income	\$130,373	\$134,979	\$143,462
Daytime Population	26,601	101,742	237,831

\* Demographics are 2021 Estimates  
2021 SITES USA, INC.

**Interested in more information? Please Contact:**

**ANDREW ROSE** | [arose@nextrealtymidatlantic.com](mailto:arose@nextrealtymidatlantic.com) | 703.442.8837

**GRAY MCGREGOR** | gmcgregor@nextrealtymidatlantic.com | 703.442.8834



# MARKET AERIAL



186,000 AADT

FAIRFAX COURT

**Burlington**  
Coat Factory  
**XSPORT**  
FITNESS  
Pier1Imports

**H MART**

KAMP WASHINGTON

**CHIPOTLE**  
**PGA TOUR SUPERSTORE**  
**PET SUPPLIES PLUS**  
**MOD**  
**GOODYEAR**  
**CAVA**  
**JJ**

**99 Ranch Market**  
**Party City**  
**petco**

FAIRFAX MARKETPLACE

**Sprint**  
**FedEx Office**  
**FIVE GUYS**  
**Starbucks**  
**WELLS FARGO**

POINT 50  
48,101 SF  
Redevelopment

BOULEVARD MARKETPLACE AT FAIRFAX  
**ABC Fixenza**  
**7 ELEVEN**

58,000 AADT

**Lowe's**  
Home Improvement Warehouse

29

FAIRFAX POINTE

**T-Mobile**  
**DUNKIN' DONUTS**  
**ZOE'S KITCHEN**

OLD TOWN PLAZA

**RED EFFECT**  
**yogaworks**  
**MASSAGE GREEN**  
**Sylvan**  
**Pacers**

COURTHOUSE PLAZA

**SAFeway**  
**CVS pharmacy**

**Guitar Center**  
**Big Screen**

**ALDI**  
**planet fitness**  
**Advance Auto Parts**  
**CVS**  
FAIRFAX JUNCTION

FAIRFAX COUNTY COURTHOUSE, GOVERNMENT & JUDICIAL OFFICES

123

MAIN STREET MARKETPLACE

**ACE Hardware**  
**TJ-maxx**  
**Walgreens**

FAIRFAX CENTER I & II  
**Walmart**

620

**GEORGE MASON UNIVERSITY**

34,000+ Students  
5,600 Staff  
6,200 Living On-Campus



Fairfax, VA



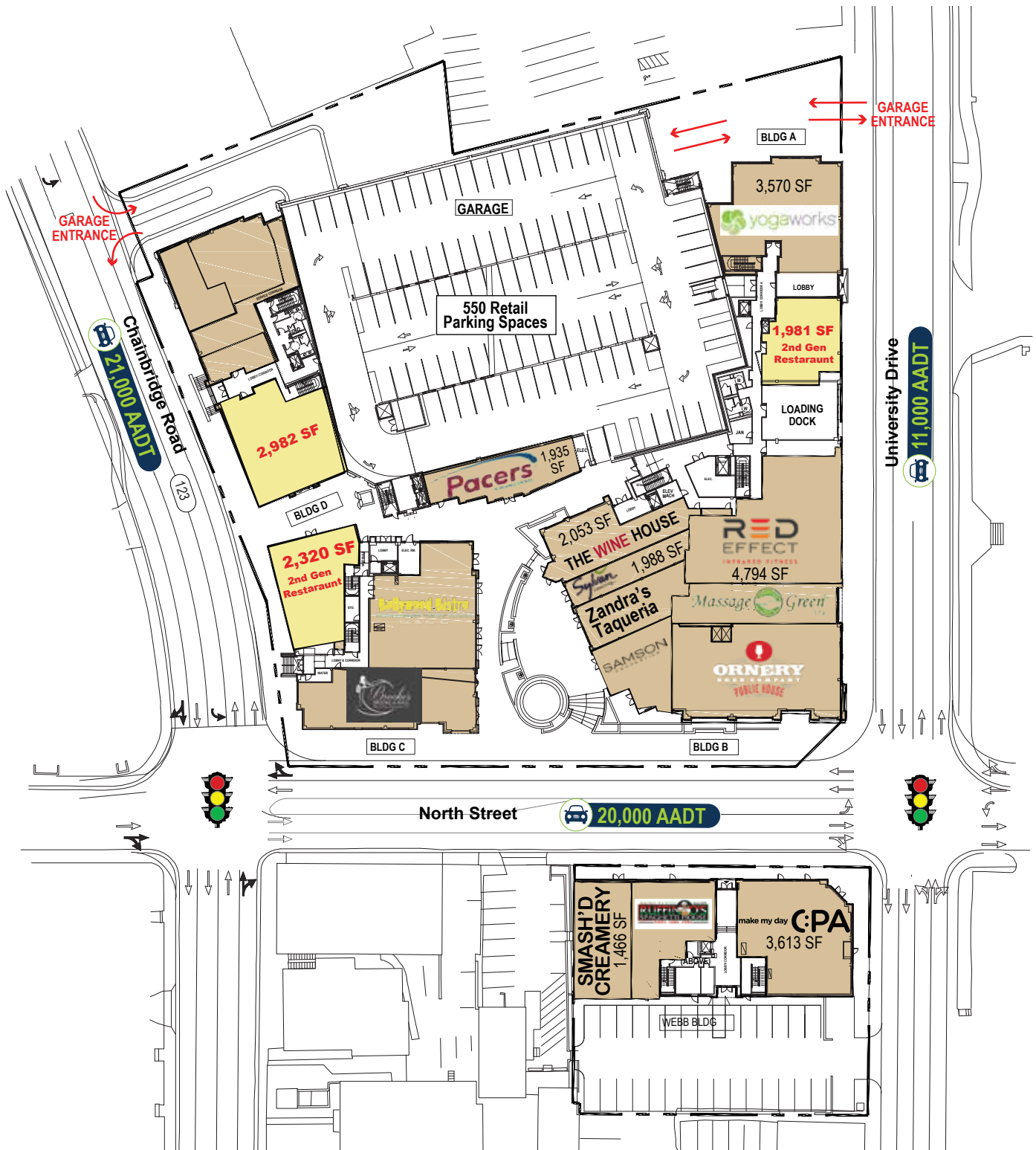

Information contained herein has been obtained from sources deemed reliable, but we do not guarantee its accuracy.



Interested in more information? Please Contact:

**ANDREW ROSE** | [arose@nextrealtymidatlantic.com](mailto:arose@nextrealtymidatlantic.com) | 703.442.8837  
**GRAY MCGREGOR** | [gmcgregor@nextrealtymidatlantic.com](mailto:gmcgregor@nextrealtymidatlantic.com) | 703.442.8834